

// 8-UNIT
**KITCHEN, DINER,
 RECREATION FACILITY (KDR)**

SAMPLE UNIT SPECIFICATIONS

- Food production and food storage capacity to serve up to 200-250 people¹
- Diner comfortably seats up to 96-150 people per sitting¹
- Walk-in freezer and walk-in cooler
- Fitness area (strength & cardio)
- TV/Rec room
- Male and female washrooms
- Large boot room at main entrance
- Office space
- Engineered for extreme climates
- Ability to complex with other equipment and corridors to create temporary fleet lodges

SAMPLE UNIT DIMENSIONS

- 8-UNIT: 56'0" x 97'

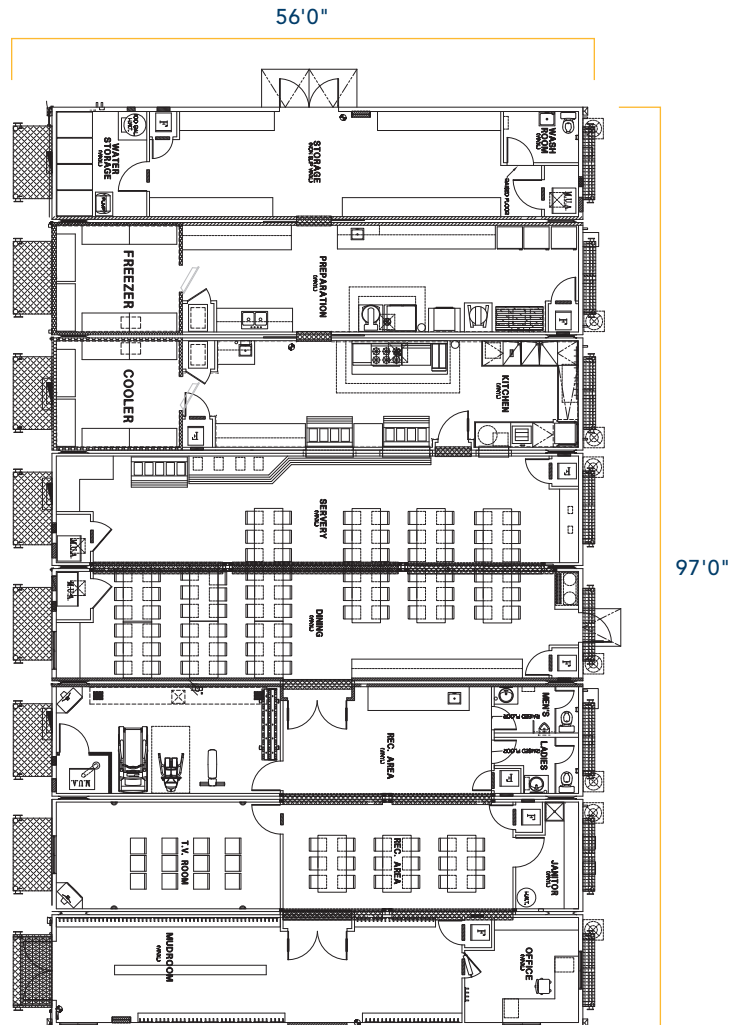

NOTES:

¹ Capacity dependent on unit configuration.

² All layouts and renderings are conceptual representations only and subject to variances.